

QPD4-100-500-K5-7

4-Way, 0.1~0.5GHz

Features:
 * Small Size
 * Low Insertion Loss

Applications:
 * Amplifiers
 * Mixers
 * Antennas
 * Laboratory Test

Electrical

Frequency:	0.1~0.5GHz
Insertion Loss:	0.6dB max.
Input VSWR:	1.3 max.
Output VSWR:	1.2 max.
Isolation:	20dB min.
Amplitude Balance:	0.2dB max.
Phase Balance:	±2°
Impedance:	50Ω
Average Power:	500W max. 100W max. as combiner

Mechanical

Size*1:	284*228*35mm 11.181*8.976*1.378in
Weight:	3600g
Connectors:	7/16 DIN Female
Mounting:	4-Φ4.4mm through-hole

[1] Exclude connectors.

Environmental

Operation Temperature: -35~+75°C

Outline Drawings

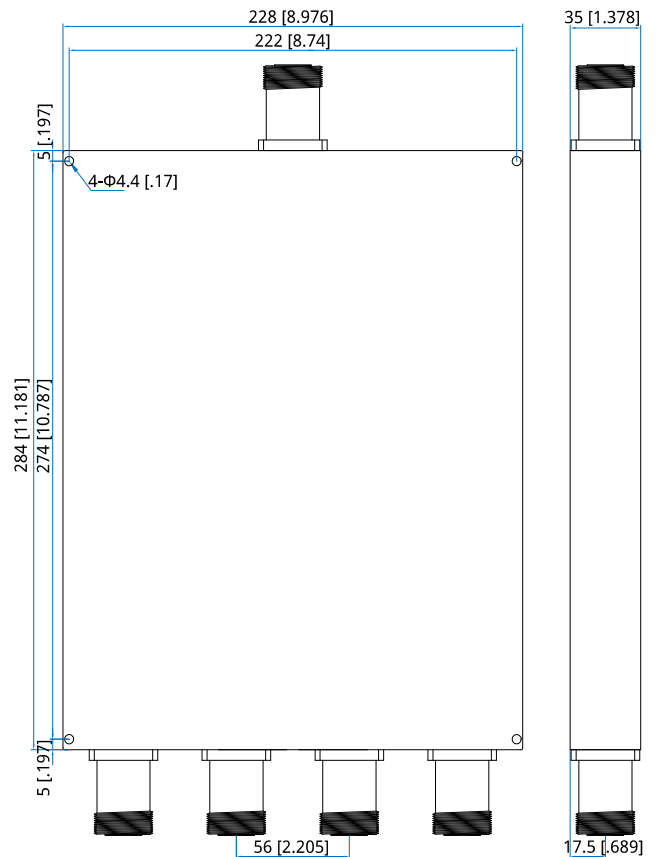

Unit: mm [in]
 Tolerance: ±0.5mm [±0.02in]

How To Order

QPD4-100-500-K5-7

Customization is available upon request.